

ExperTemp® Dispensing Gun Instructions

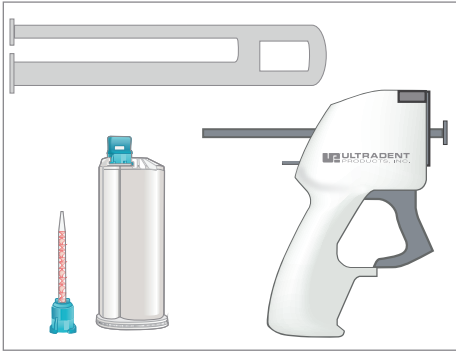

COMPONENT ASSEMBLY

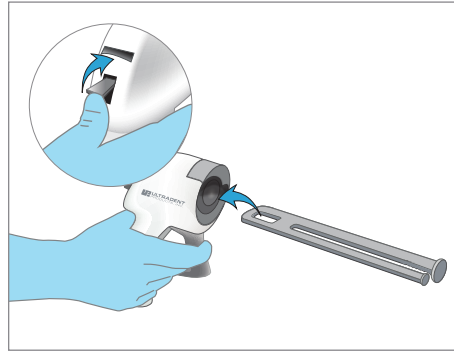

Push up the lever and insert the plunger until it stops.

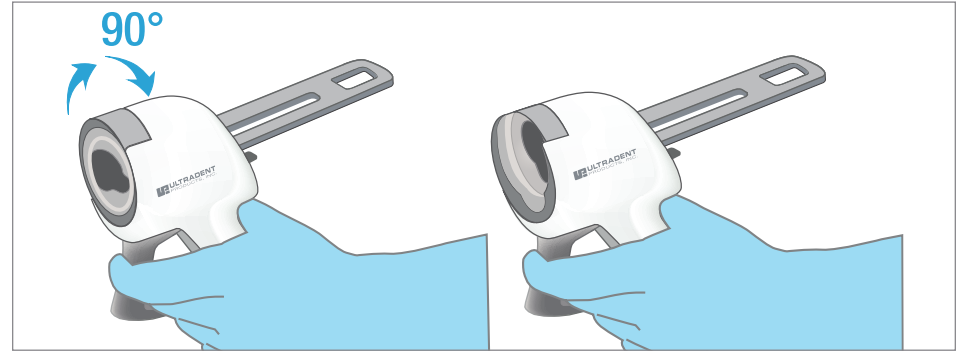

To open dispenser, rotate the ring 90° clockwise until it locks in place.

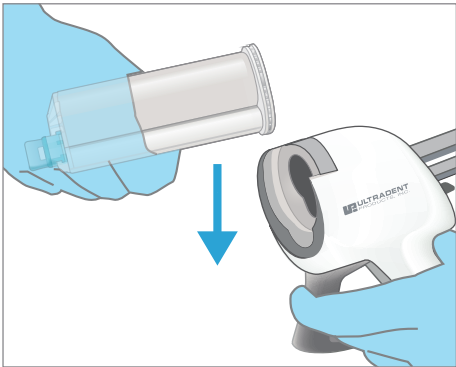

Insert the cartridge into the rotation ring slim side downward.

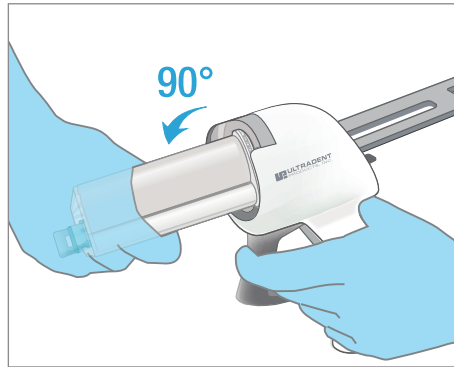

Lock the cartridge by turning it 90° counter-clockwise.

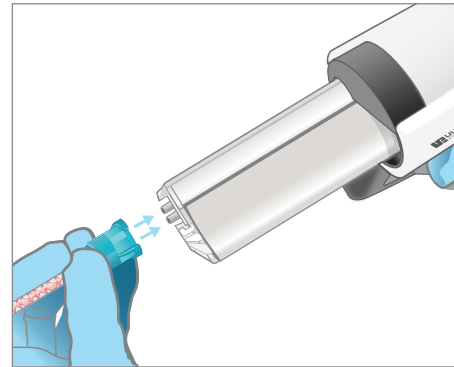

Attach the mixing tip. Note the corresponding notches.

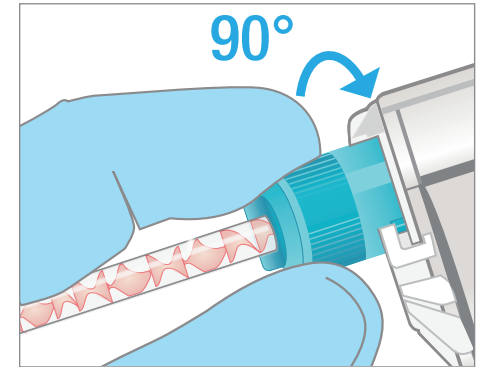

Turn the mixing tip 90° clockwise to lock it.

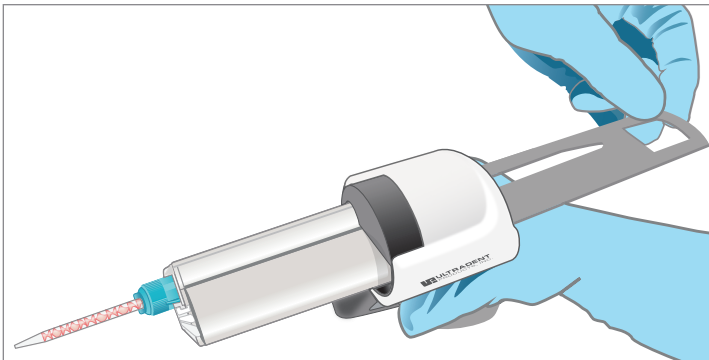

Push the plunger forward until it stops.

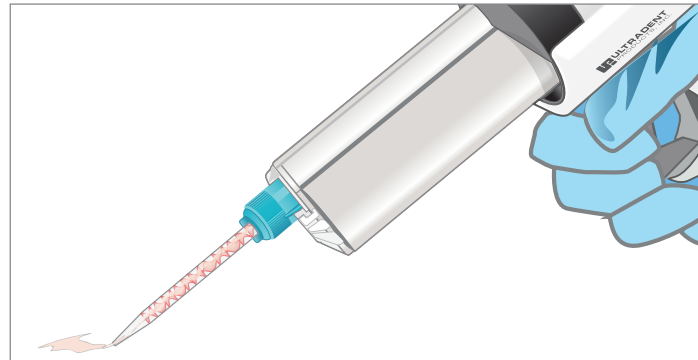

Pull the trigger until the material expresses out.